

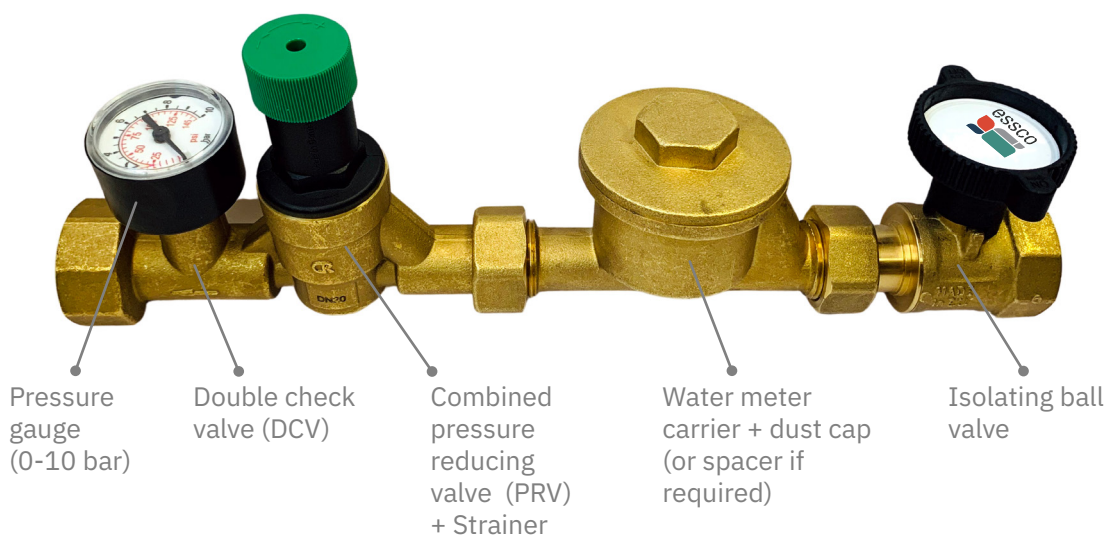

Water Meter Assembly (WMA)

For the control and measurement of cold-water supply



Overview

The ESSCO WMA provides control and measurement of the cold-water supply to multi-dwelling buildings, such as apartments and office blocks.

Supplied as standard with a water meter carrier, the WMA can be fitted with any approved water meter to match project specification.

Available in ¾" or 1" BSP female variants, the WMA is supplied with insulation as standard.



WMA with insulation as standard

Features and benefits

- Compact and space saving (Half the size of traditional branch valve assemblies)
- Easy to install, either horizontally or vertically
- Position of water meter can be adjusted to suit, making it easy to read the display
- Supplied pre-tested to save time on site
- Robust, with minimal service and maintenance requirements
- Supplied with carrier, ready to fit any approved water meter (or with 80-110mm spacer where required)
- Dust cap on water meter carrier protects from contamination during installation
- Supplied with insulation as standard, which provides protection and makes a neat installation
- Kiwa UK Regulation 4 (KUKreg4) approved for peace of mind

Water regulations

Current Regulations stipulate the requirement for both Service valves and Double Check Valves on each level of a multi-floor dwelling. Clause R15.24.1 requires precautions to be taken to prevent or limit back flow in supply pipes. Clause R15.24.3 recommends additional protection be installed at every floor. Assuming the backflow risk is Category 3 or below a DCV assembly can be installed downstream of the service valve.

The ESSCO water meter assembly provides compliance with current water regulations.



Technical Specification

Dimensions

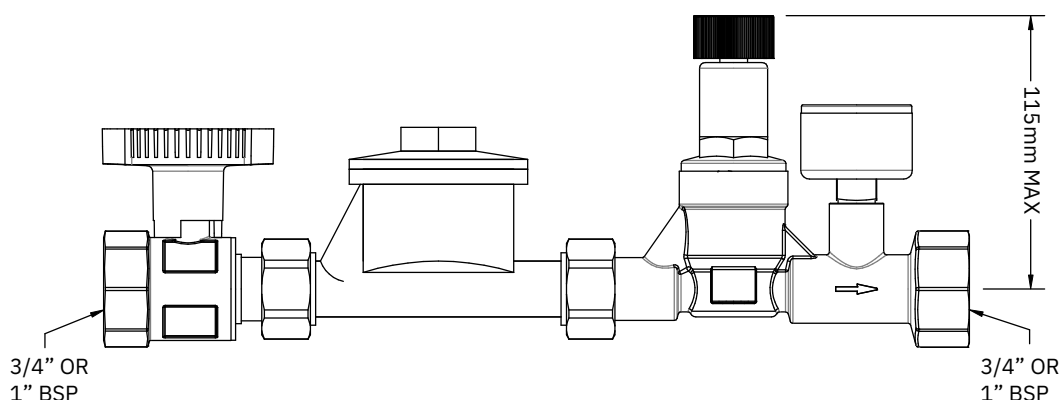
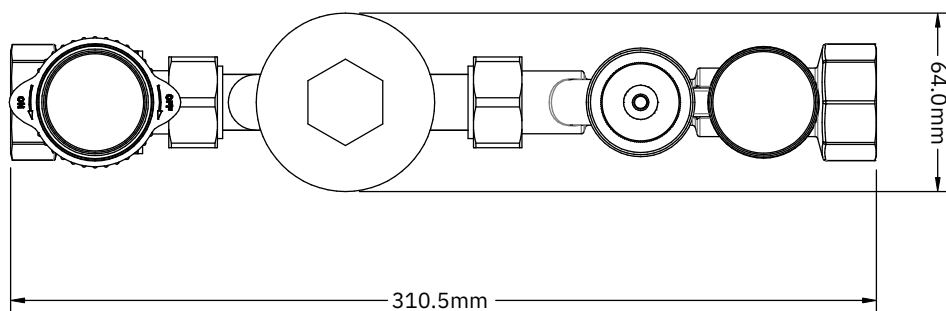

Specification	
Maximum operating pressure	10 Bar
Minimum operating pressure	1 Bar
Maximum temperature	85°C
Minimum temperature	5°C
Pressure range	1.5 – 6 Bar
Connections	¾" BSP or 1" BSP
Water meter carrier connection	DN40 Internal thread, screwed
Installation	Vertical or horizontal
Strainer	350 Micron
Insulation	Standard
Material	D2R Brass EPDM Seals
Approvals	Kiwa Regulation 4 (KUKreg4)
Media	DCW / Potable water



Water Meter Carrier

Specification text

A pre-assembled water meter assembly comprising of extended lever isolation valve, water meter carrier, pressure reducing valve (PRV), double check valve (DCV) and pressure gauge combi module. Insulation cover as standard, to allow access to isolation valve, water meter, PRV and gauge as required.

Product codes

Standard WMA with 110mm carrier:

ESS-90501035-CARRIER (¾")
ESS-90501101-CARRIER (1")

WMA with 80mm spacer:

ESS-90501034 (¾")
ESS-90501100 (1")

WMA with 110mm spacer:

ESS-90501035 (¾")
ESS-90501101 (1")

WMA carrier suitable for

Class D meters:
ESS-WM-CARRIER



essco
OEM

Technical Specification

Flow rates



The graph below shows typical flow rates through the water meter assembly with a valve set pressure of 3 bar.

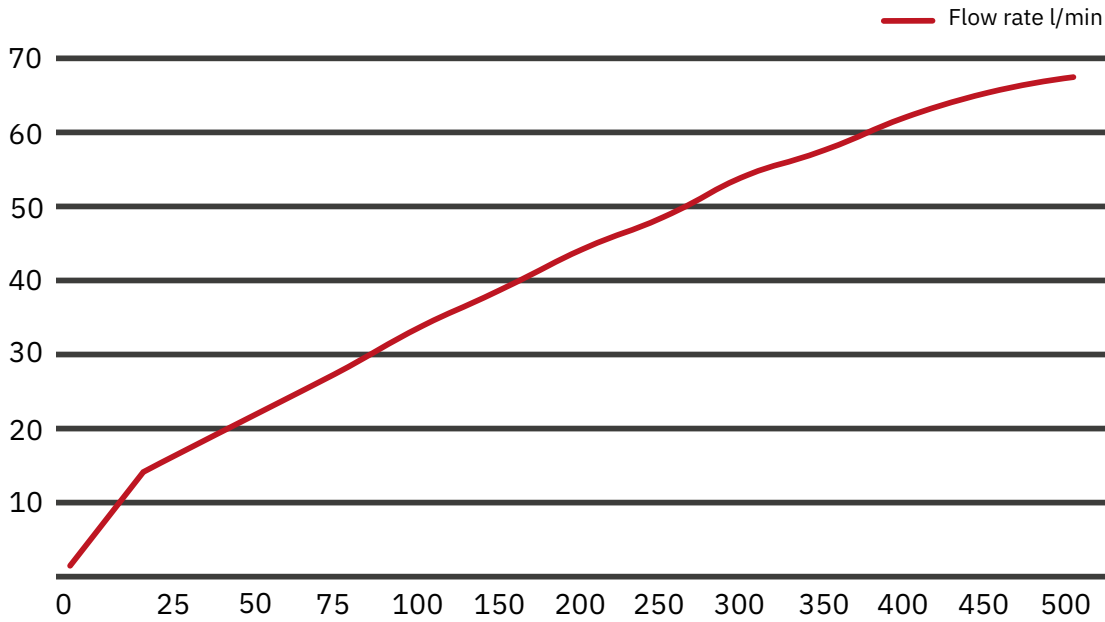

Pressure (kPa)	=	Flow rate (l/min)
0		0
25		14
50		22
75		28
100		34
150		39
200		44
250		49
300		54
350		58
400		62
450		65
500		68