

EVDBPX Detachable Bypass Valve (DBP)

For flushing of secondary circuits on a heat network (insulation optional)



Overview

The Detachable Bypass Valve (DBP) is a compact multifunction valve arrangement, designed to provide isolation, bypass and measuring points as required. These valves are typically fitted prior to a heating or cooling interface unit on a heat network. Ball valves are required after the bypass to ensure flow can be isolated to the interface unit, so that full bypass will take place during flushing.

Features and Benefits

- Full bore for maximum flow rate with lower pressure drops
- PN16 pressure rated
- Heavy pattern brass valves with stainless steel bypass pipe for quality
- Supplied with binder test points and bypass pipe as standard, with optional insulation shells



Technical Specification

Specification		
Medium	Heating/cooling, glycol	
Maximum glycol concentration	30%	
Maximum working pressure	PN16	
Working temperature range	5 – 95°C	
Installation	Vertical or horizontal	
Heat network side connections	¾" M	
Interface unit connections	¾" F	
	Material	PE
	Density	30 kg/m³
Insulation Specification	Thermal conductivity at 10°C	W/mK 0.0320
	Thermal conductivity at 40°C	W/mK 0.0404
	Fire resistance	DIN75200 mm/min < 100

Product Codes

Product Code	Insulated	Pipe Spacing	Configuration Weight (kg)		
			Bypass	Test	Normal
EVDBPX-050	No	50mm	0.880	0.870	0.730
EVDBPX050	Yes	50mm	0.895	0.885	0.745
EVDBPX-XXX	No	XXX mm	(will depend on XXXmm)		
EVDBPXXXX	Yes	XXX mm	(will depend on XXXmm)		

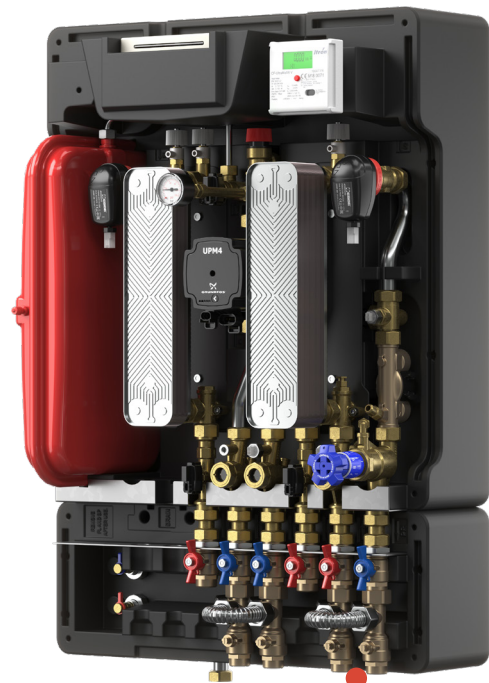

Detachable bypass valves fitted on EDGE-T HIU

Technical Information



Materials

Component		Material	Grade	
1	T-Piece	Valve body, nuts	Brass	CW617N
		Square stem	Brass	CW614N
		Ball	Brass	CW617N
		O-Rings	Rubber	EPDM
		Washer	Rubber	EPDM
		Circlip	Stainless steel	AISI302
2	Locking cap	Locking cap	Brass	CW617N
		Inside flat seal	Rubber	EPDM
		Strap	Plastic	PP
3	Corrugated pipe	Pipe	Stainless steel	AISI304
		Locking nuts	Brass	CW617N
4	Binder test points	Locking nuts	Brass	CW617N
		Test points	Brass	CW617N
		Inside seals	Rubber	EPDM
		Strap	Plastic	PE
5	Insulation (optional)	Plastic	PE	

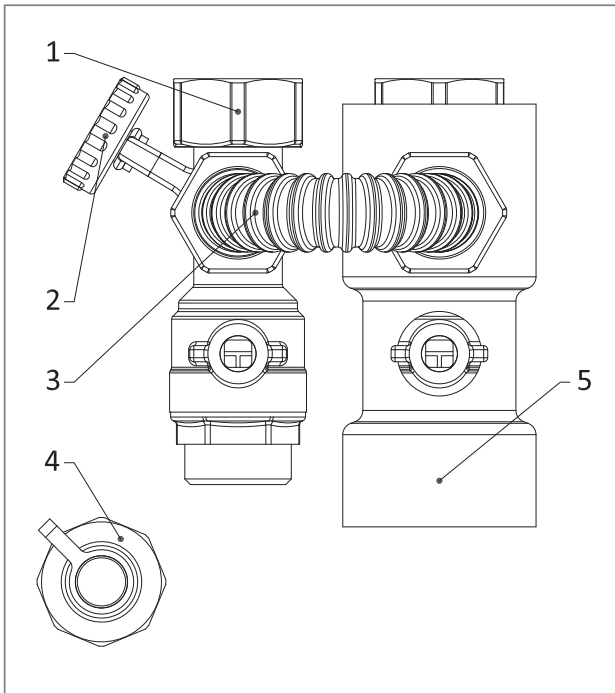

Modes of Operation

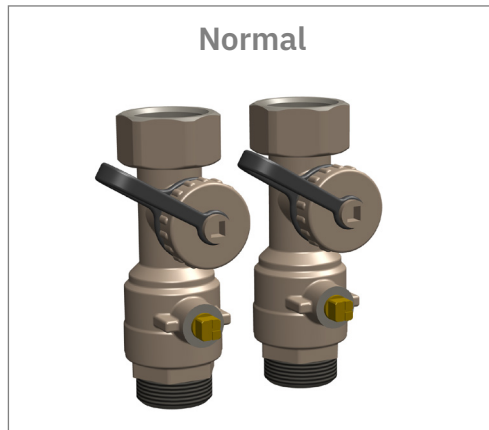
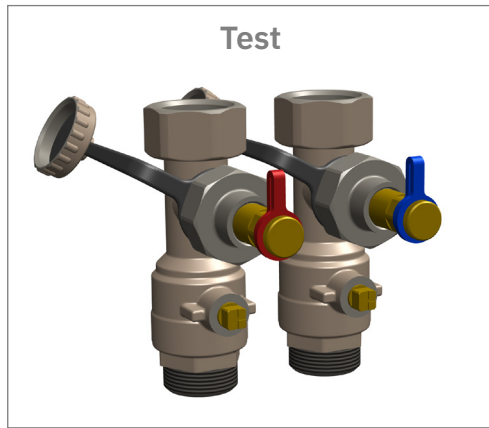
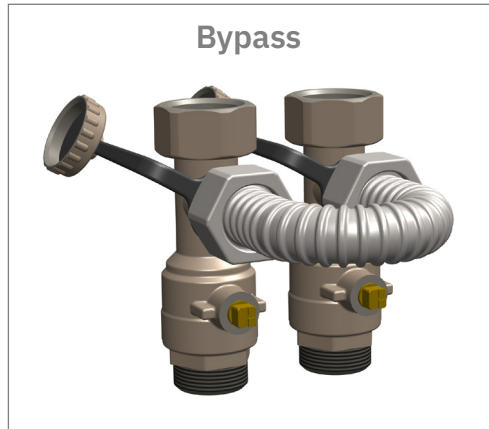

Dimensions



EVDBPX-XXX (Excluding insulation)

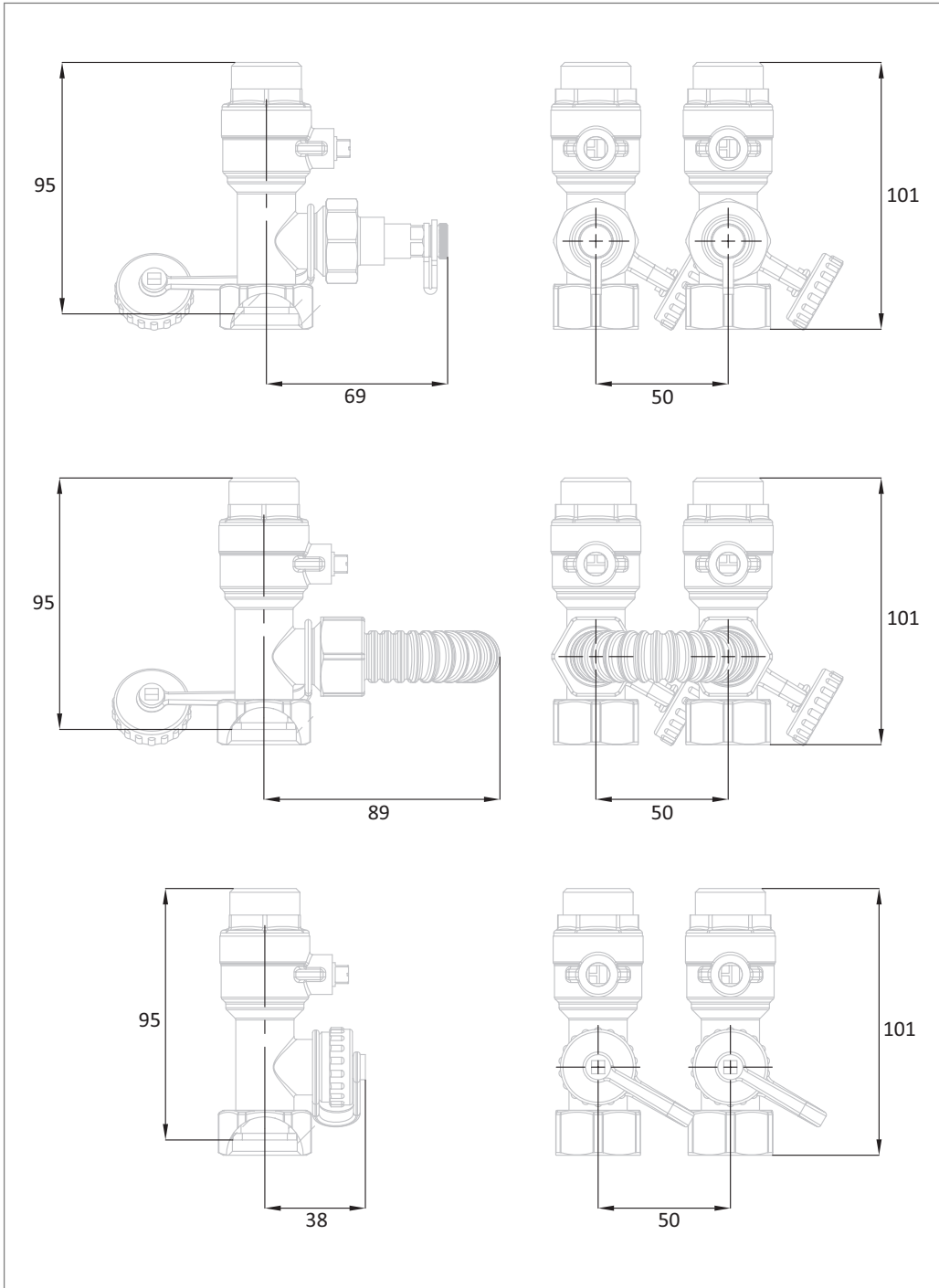

Dimensions



EVDBPXYXXX (Including insulation)

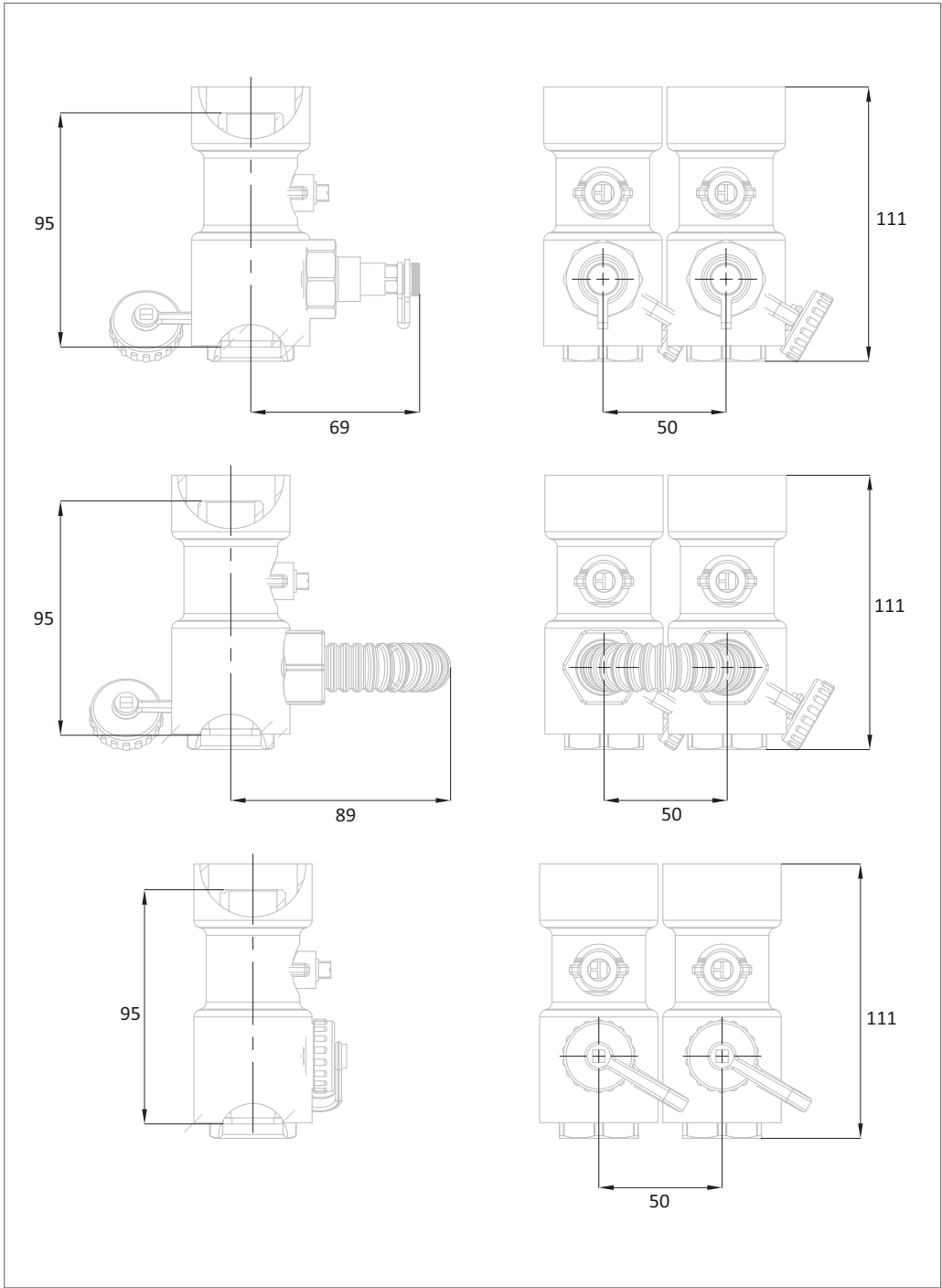

Pressure Drops



Mode of Operation	Bypass	Test	Normal
Kv	14.5	23	23

Bypass Mode (Kv = 14.5)

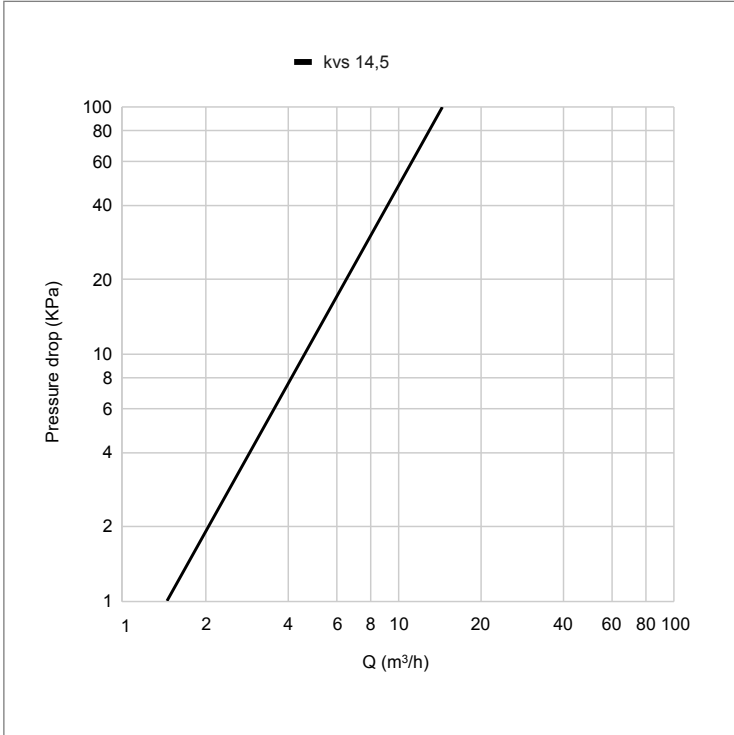

Test / Normal Mode (Kv = 23)

